



- November, 2017
- **Orbit Hybrid 7190g Swifel Base**
- Dominik Schuster
- S&PS Scanning E2R (East-to-Rest) Products

**Honeywell**

# Orbit 7190g Introduction of the Swivel Base

## Purpose of the base

Traditionally, the presentation scanners are designed for merchandise scanning in cashier-facing position, and except for merchandise scanning, Orbit 7190g will be used for consumer to scan digital barcodes off their personal smart devices, and therefore additional base was designed and offered to make 7190g be able to be consumer facing in such digital codes reading applications.

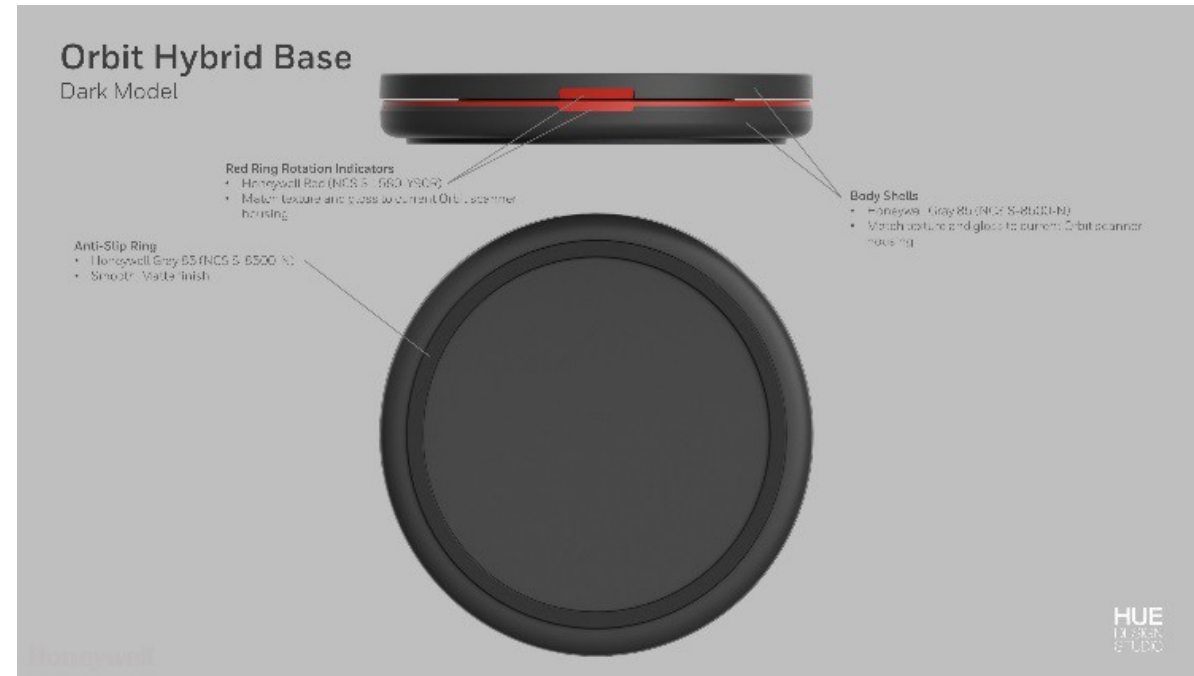
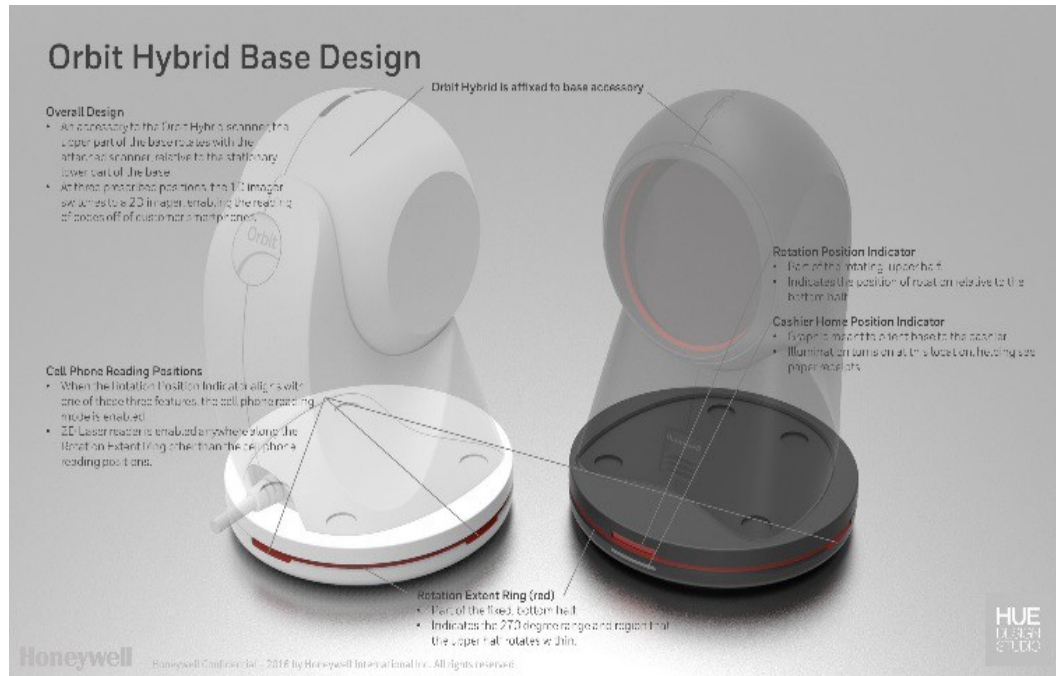

# Orbit 7190g Introduction of the Swivel Base

## How to use the swivel base?

1. How to rotate it? As following, it's able to be rotated in 90°, 180° or -90° position.

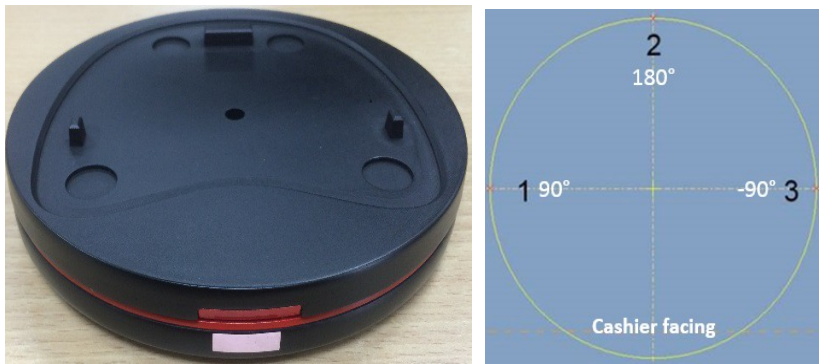

2. How to work? Put the scanner on the base



- When the scanner is in cashier-facing position, it will be either in **Mobile Phone Read Mode** or **Presentation Mode** which can be configured by user (see the “Frequently Used Scanning Modes”).
- When the scanner is rotated in any consumer-facing (90°, 180° or -90°) position, the scanner will **automatically** enter into mobile phone mode with **digital code reading performance optimized** and the **laser/LED illumination will be turned off** as well to **avoid annoying users**.
- When the scanner is rotated back to cashier-facing position, the scanner will **automatically** enter into the mode, which was user configured before rotation.



# Orbit 7190g Introduction of the Swivel Base

## How the Swivel Base / Scanner knows in which position they are?

1. It's able to be rotated in 90°, 180° or -90° position.

If turning around the scanner the laser will be switched off and the imager Cell Phone Mode will be enabled!

This is handled by a Hall Sensor – reed contact @ 90° and 180°

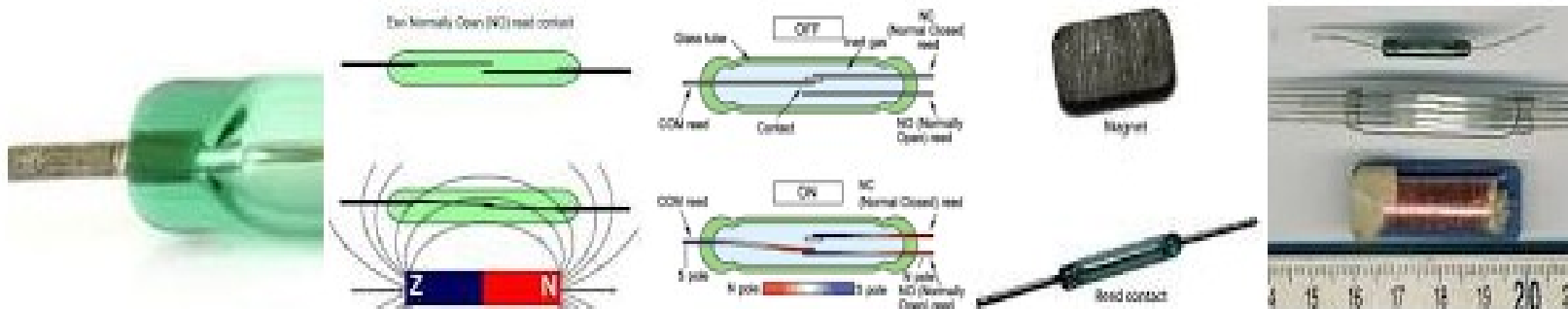

The reed switch is an electrical switch operated by an applied magnetic field.

# Operating Mode Proposal (Swivel Base)!

Mode and UI behavior Definition						
	Working Mode			Sleep Mode		
	On Base		Out of Base	On Base		Out of Base
	Customer Faced	Cashier Faced		Customer Faced	Cashier Faced	
<b>White Indicator</b>	Flash then off on good read	Flash then off on good read	Flash then off on good read	OFF	OFF	OFF
<b>Blue Indicator (RoW)</b>	On	On (there is risk that could not pass USB compliance due to additional power consumption).		On	On	On
<b>Blue Indicator (GC)</b>	On	On	On	On	On	On
<b>Laser</b>	Off	On	On	OFF	On	On
<b>Imager illumination (RoW version only)</b>	Off	illumination on/off alternatively > So called "Cellphone Mode" > 7 frame illumination on/7 frame illumination on (the LED will flash*) > Read both paper and digital > cell phone reading is the "best", but printed codes is compromised, but acceptable (to be verified)		Off	Off	Off

Mode Switching	
<b>Working Mode -&gt; Sleep Mode</b>	Timeout 0.5 seconds
<b>Sleep Mode -&gt; Working Mode</b>	Laser trigger